

FIELD CONNECTOR SC-APC FLAT DROP CABLE - METAL V GROVEE TECHNOLOGY

AR-FCSC-APC-MVG

1. DESCRIPTION

The ARTIC FIBER OPTIC this kind of Field Assembly Optical Connector is designed for fast and simple field termination of single fiber, without polishing or epoxy. The Connector is made with precision metal V-groove and high quality Zirconia ferrules and provides a highly reliable connection in most of the network application. The SC type is available with 2.0 x 3.0mm jacket cable.

Application

- 1) All fiber interconnection;
- 2) Telecom Distribution and Local Area Networks;
- 3) FTTH and FTTx;
- 4) Passive optical networks [ATM, WDM, Ethernet];
- 5) Broadband, Cable TV (CATV).

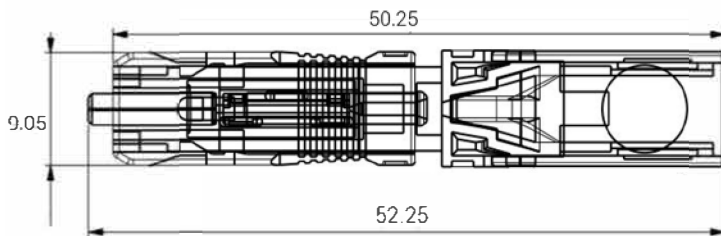

SC Shell

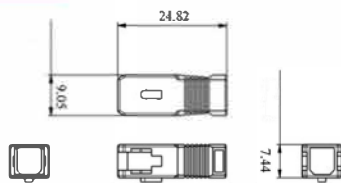

V-groove Body

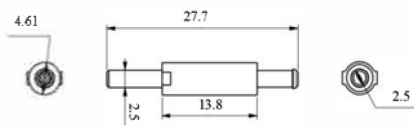

Dust Cap



Connector Body

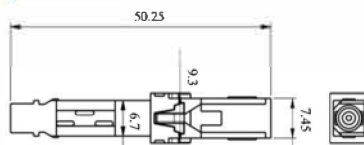

Cable Clamp

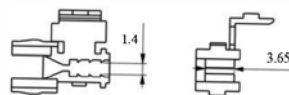

Tail Cover

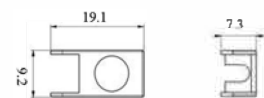

Keyed Characteristics

- 1) Comply with TIA/EIA and IEC;
- 2) Quick and easy fiber termination;
- 3) RoHS compliant;
- 4) Reusable termination capability (Up to 10 times)
- 5) Easy to deploy fiber solution;
- 6) High success rate of connections;
- 7) Low Insertion & Back Reflection;
- 8) No special tools required.

2. TECHNICAL SPECIFICATION

Category	Specification	
Applicable for	3.0x2.0mm Drop Cable	
Fiber mode	9/125 μ m Single-mode	
Polish Type	APC/UPC	
Dimension	52mm	
Housing	Green and Blue	
Ferrule Material	Ceramic (Zirconia)	
Operation Time	S	About 50 (no fiber cut)
Insertion Loss (Typ.)	dB	≤ 0.20
Insertion Loss (Max.)	dB	≤ 0.40
Return Loss	dB	≥ 45.0
Fastening Strength of Naked Fiber	N	≥ 5
Tensile Strength	N	≥ 50
Reusable	Time	≥ 10 times
Operating Temperature	$^{\circ}$ C	-40~+75
On-line tensile strength (20N)	dB	$\Delta IL \leq 0.3$
Mechanical Durability (500 times)	dB	$\Delta IL \leq 0.3$
Drop-off test (drop-off height 4m, once per direction, totally 3 times)	dB	$\Delta IL \leq 0.3$
Conformance	TIA/EIA 604-3	

Packing Details for Reference (or Meet Customized Standard) Blister Box Packing - Usage Instruction Included

Size (mm)	150*90
QTY (PCS/Bag)	10
Net Weight (KG/PCS)	0.003

3. INSTALLATION MANUAL

Safety Precaution

Protective Eyewear

Δ CAUTION

To reduce the risk associated with eye injury: - Safety glasses should be worn when handling chemicals and cleaving the optical

Chemical Precautions

Δ WARNING

To reduce the risk associated with fire: - Storage, use and disposal of isopropyl alcohol should be per your company health, safety and environmental instructions. Refer to material safety data sheet for health hazards safe handling, proper use and control measures.

Δ CAUTION

To reduce the risk associated with eye or skin irritation from fiber gel in connector: - Product contains phenylmethyl silicone (63148-58-3), hydrophobic silica (68611-44-9) and may cause minimal eye irritation. Avoid contact with eyes and wash hands before eating or smoking. Upon eye contact, immediately flush eyes with water while holding eyelids open and continue Flushing for ten minutes. Contact a physician. Upon skin contact, wash with soap and water.

Bare Fiber Handling

Δ CAUTION

To reduce the risk associated with handling sharp glass fibers: - Cleaved glass fibers are sharp and can pierce the skin. Use tweezers when handling shards and dispose of them properly per your company health and safety instructions.

Fiber/Cable Handling

⚠ NOTICE

To reduce the risk associated with fiber damage: Optical fiber can be damaged by excessive tensile, compressive and bending forces. Consult the manufactures specifications for proper handling instructions.

Laser Safety

⚠ CAUTION

To reduce the risk associated with eye damage from exposure to laser light: Take the proper precautions when working with optical fiber because invisible laser light may be present. The principal laser hazard when working with fiber optics is injury to the eye. Never look directly into the fiber or connector using the naked eye or a microscope.

• Connector Structure

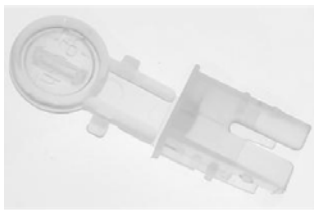

Dust Cap

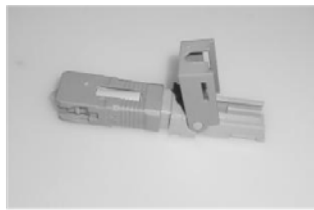

Connector Body



Cable Clamp

• Required Tools - Reagent Grade Isopropyl Alcohol is required, but not supplied.



Cable Holder (Black)



Fiber Stripper (Green)



Fiber Cleaver



Cable Stripper



Isopropyl Alcohol



Dust-free Wipes

• Installation Procedure



1, Mark 50mm using cable stripper remove outer jacket.

① Insert 2mm side into cable clamp.

② Make sure there is no gap between the cable and jig.

Bending fiber (>60°) in 4 directions and a least 3 times to do fiber screening to check if any fiber broken



3, Put cable clamp onto the black jig.

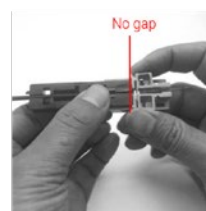

4, Tightly contact with fiber stripper, and hold it.

CAUTION: If fiber broken during bending, need to reserve another 50mm fiber.

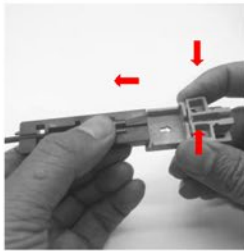

5. Push the stripper, pull out slowly strip off the fiber.



6. Bending fiber(>60°) in 4 directions and a least 3 times to do fiber screening to check if any fiber broken.

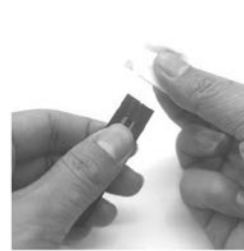

7. Using dust free wipe and cleaning the fiber.

CAUTION: Fiber can't be broken during cleaning.



8. Using fiber cleaver cut off bare fiber.

CAUTION: There is no gap between black jig and cleaver.



9. Cutting fiber.

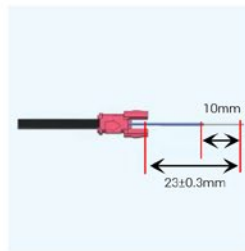

10. Take off from black jig.

Cutting length. (Picture shown only for reference)

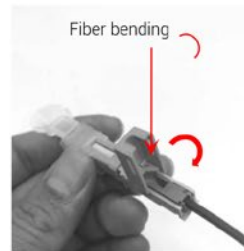

11. Insert the fiber into SC connector until the cable clam is insert totally.

Can notice "ka-ca" click sound.



12. Press the tail cover.

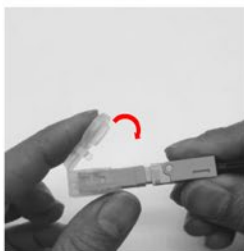

13. Rotate actuation lever on dust cap.

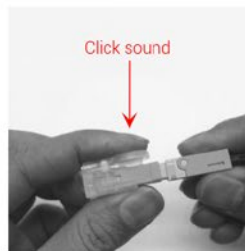

14. Press dust cap and completely installation.

● Re-open the connector



1. Using dust cap into two slots on SC shell.



2. Using black jig open tail cover.

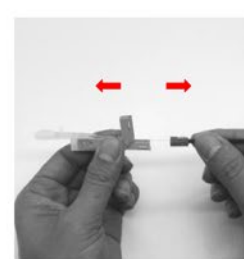

3. Pull out the fiber from The connector.

Open the cable holder and pull out the cable, complete the repeat assembly.

Accessories including

- 10PCS Dust-free Wipes
- 1PCS Cable Holder (Black)
- 1PCS Fiber Stripper (Green)
- 1PCS Manual Installation Guide

Accessories including

- 10PCS/PE Bag
- PE Bag Size: 15cm x 17cm
- Weight: 68.9g/10PCS



1PCS Individually Candy Bag



10PCS/PE Bag



68.9g/10PCS

● Inner Box Packing

	Size (CM)	23 x 20 x 10
	QTY (PCS / Inner Box)	200
	Net Weight (KG / Inner Box)	1.5kg

● Inner Box Packing

	Size (CM)	49 x 32 x 32.5
	QTY (Pcs / Carton)	2000
	N.W (KG / Carton)	15
	G.W (KG / Carton)	15.5